



**A**dvanced

**R**im

**L**ug

**I**nternal

**E**xterior

**CLEANING  
TOOL**



## MEET ARLIE

Designed to quickly clean the lug stud and mating surfaces of truck wheel components, ensuring proper torque can be applied and proper clamping force is achieved.



**CAUTION:**

This tool contains parts with sharp edges. Use gloves when handling.

## OPERATION

1. Attach to any power driven tool (pneumatic, electric, or battery) that accepts a 1/2" square drive.
2. Use a clockwise rotation at all times, on and off the stud.  
**DO NOT REVERSE**
3. While rotating, engage the tool onto the stud and press firmly against hub.
4. Stabilize the tool with one hand, and work the tool forward and backward until all rust and debris is removed.

**MAX ROTATION: 4000 RPM**



ALWAYS WEAR PROPER PERSONAL PROTECTION EQUIPMENT WHILE USING THIS TOOL.



**SCAN HERE**

To Order Replacement Heads & Brushes

**OR EMAIL US AT**

[sales@infiniteconceptsmsg.com](mailto:sales@infiniteconceptsmsg.com)

INFINITE CONCEPTS  
+ Mfg.



## INSTRUCTION GUIDE



[INFINITECONCEPTSMFG.COM](http://INFINITECONCEPTSMFG.COM)

## CLEANING HEAD REPLACEMENT

## INTERIOR BRUSH REPLACEMENT

## PARTS LIST



1. Align large diameter slots on cleaning head, with head of retaining bolts



2. Rotate clockwise after contacting bottom of cleaning head with face of body.

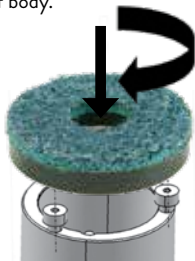

3. Align, push down and rotate clockwise to lock.

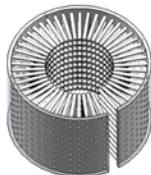

1. Curl replacement inner cleaning brush to form a tube.

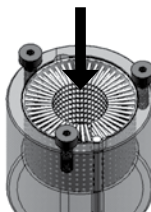

2. Push replacement brush into the main tool body.

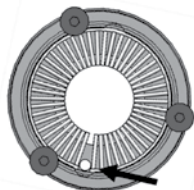

3. Align ends of the brush with the anti-rotate pin.

### AT-001 - ARLIE TOOL



### AT-002 CLEANING HEAD

### AT-004 RETAINING BOLT

### AT-003 INTERIOR BRUSH

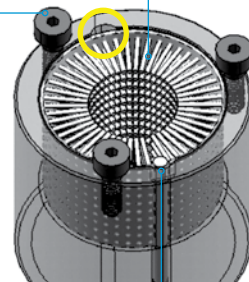

### AT-005 ANTI-ROTATE PIN

**TIP:** Use screwdriver or needle-nose pliers in the pry slot to remove Interior brush